



## The All-in-One Contactless, Chip and Swipe Card Reader

Go here. Go there. Accept payments anywhere. Clover® Go Contactless Reader is your go-to point-of-sale device for credit card swipes, dips, and taps. Just bring your smartphone or tablet and a free hand.



### Fast

No matter how your customer is paying, contactless, EMV® chip, or traditional swipe, Clover Go can take it – and get you paid fast.



### Smart

Big things come in small packages. With Clover Go, you get sales reporting, business insights, and more.



### Flexible

The Clover platform provides a variety of hardware and software solutions that grow with you as your business evolves.



**Less to worry about with Clover in your corner:**

**Data Protection** – Clover Security can help protect your business and customers.

**24/7 Support** – Get help when you need it. Our knowledgeable support team is available to address your questions or issues whenever they arise.



# Tap. Dip. Swipe. Repeat. All day. Every day.

Whether you're running around town or running around your store, the Clover Go mobile point-of-sale device and the Clover Dashboard management portal place additional features at your fingertips.

## Connect Wirelessly

The Clover Go pairs seamlessly with your mobile device or tablet through a Bluetooth® connection.

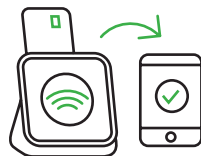

## Tips & Taxes

Set custom percentage amounts for tips and create multiple tax rates for the things you sell.



## Paperless Receipts

Customers want it their way, right down to the receipt. With Clover Go, it's simple to email or text receipts to your customers to keep them happy.



## End-to-End Security Software

Built-in Clover Security can help protect your customers, business, and reputation from fraud.



**First Data**

For more information, please contact your CBE